



7865.N1.80903.20

NEW 900 4 BURNER COUNTERTOP GAS COOKER 80*90*30 (2x6+2x10=32 kw) Version No: V13.01

SPARE PART LIST

Spare Part ItemCode	Item name.	PictureId
6260.00002.05	ADJUSTABLE LEG M6	16
6260.00058.96	FLUE COVER CAST IRON WITH CERAMIC ENAMEL COATED FOR ALL 700&900	2
9099.00A60.00	GAS VALVE MAX-MIN ADJUSTMENT PILOT OUTPUT WITH THERMOCOUPLE SAFE 21S	20
6260.00015.46	THERMOPLASTIC KNOB MAIN BODY WITH 8 mm INSERT	21
6260.00015.40	THERMOPLASTIC KNOB SCALE MAX.-MIN FLAME-LIGHTING	22
2KLP.460.626700006.05	MAIN BURNER NOZZLE M8x0,75 ANY GAS TYPE	28
6267.00020.33	PILOT BURNER ASSEMBLY LONG FOR 900 SERIES COOKERS	3
6267.00002.046	BURNER ASSEMBLY 10 Kw FOR 900 SERIES GAS COOKERS	30
6267.00002.048	BURNER ASSEMBLY 6 Kw FOR 900 SERIES GAS COOKERS	37
2179.09028.01	LABEL FOR FRONT PANEL "ÖZT RYAK LER"	38
6267.00020.51	PILOT ASSEMBLY SHORT	39
6267.00024.00	THERMOCOUPLE 9/1 600 mm LENGTH	4
6260.00058.43	PAN SUPPORT CAST IRON W CERAMIC ENAMEL COATED FOR 900 SERIES COOKERS	5
2865.N20.08000290.G.10	FRONT PANEL FOR 80'S GAS COOKER	6



DIKKAT: BU DÖKÜMANIN COĞALTILMASI, İNTERNET ORTAMINDA DOLAŞTIRILMASI VE BU ÇİZİMLER DOĞRULUĞUNDA ÜRETİMİN YAPILMASI ÖZT RYAK LER FİRMASININ ONAYI İLE OLABİLİR. TÜM HAKLARIMIZ SAKLIDIR.

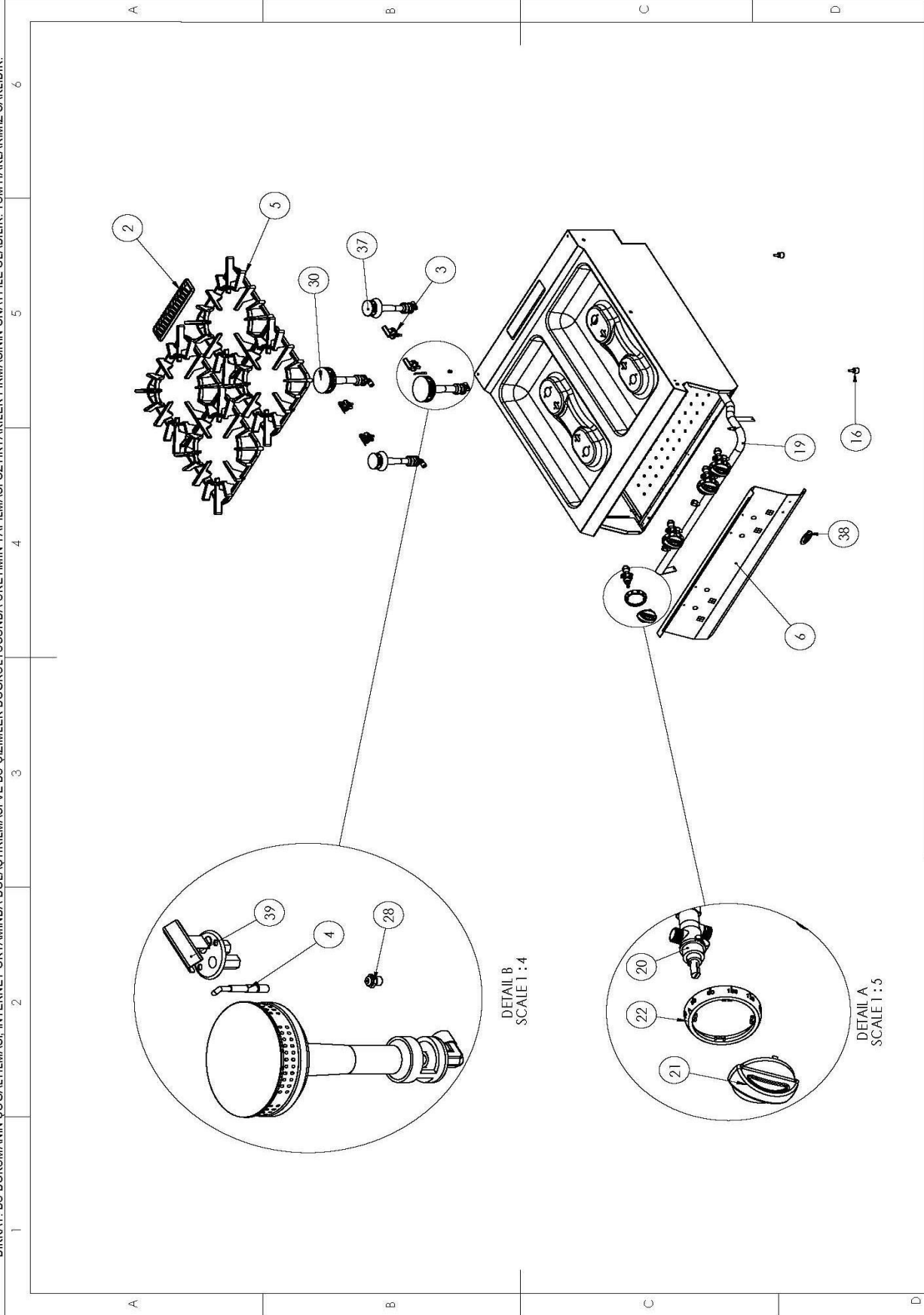

RİSİD		BİM	İMÇÄ	TARİH	MATERİAL	TOLERANS	
ÇİZEN	E.BAŞTUĞ			22.12.2012		DIN 71 68	
KONTROL	M.HACI			22.12.2012		ORTA	
ONAY	M.HACI			22.12.2012			
ĞİRLİK(Gr.)	610249	KALINLIK		REVİZYON	1	ÖLÇEK	
TÜM ÖLÇÜLER mm ÇİNSİNDİR						1:50	
						T. RESİM NO	
						OSOG 8090 patlamış	
ARGE							özti
KONTROLLÜ KOPYA							PARÇA ADI
							4 lü gazlı ocak
V13.01							

WARNING: IT IS APPROPRIATE TO MULTIPLY, USE, DISPLAY AT COMPUTER/INTERNET AND PRODUCE THE PRODUCT WITH ITS DRAWINGS WITH THE APPROVAL OF ÖZT RYAK LER COMPANY. ALL RIGHTS RESERVED.